

BLAUPUNKT

ESTABLISHED
IN
GERMANY
Since 1923

G-Sensor
Micro SD
Wide-Angle
Loop-Recording



Enjoy it.

BP 2.0 FHD
1 131 499 100 001

User manual

Before using the product, please read this manual carefully. The manual is to guide your usage of this product specially.

Caution:

1. Please strictly abide by the relevant national laws; this product may not be used for illegal purposes, otherwise take the consequence by yourself.
2. Please insert the card according to the right direction to avoiding damage the card or DVR.
3. We suggest that clean files in the card once a week. This product is not the exclusive storage device, so please back up the important files to computer or other storage device immediately to avoid file is missing
4. Please check the bracket carefully after installation to avoiding damage caused by bad installation.
5. The working time of the battery will get shorter with the using time increase. If the DVR had not been used for a long time, please charge it before using.
6. Please do not take the product under the moist environment. It is not waterproof.
7. Please do not to take pictures or record directly to the sun, to avoid damage the optical devices.
8. Please do not use this product in excessive dust environment, in case of the lens and other component be contaminated and affect the camera effect. Please keep lens clean to use the mirror paper and glasses cloth to wipe gently.
9. This product belongs to precision electronic products, please do not intensity impact, vibration and do not use in high magnetic field and electronic field.

1. Structure

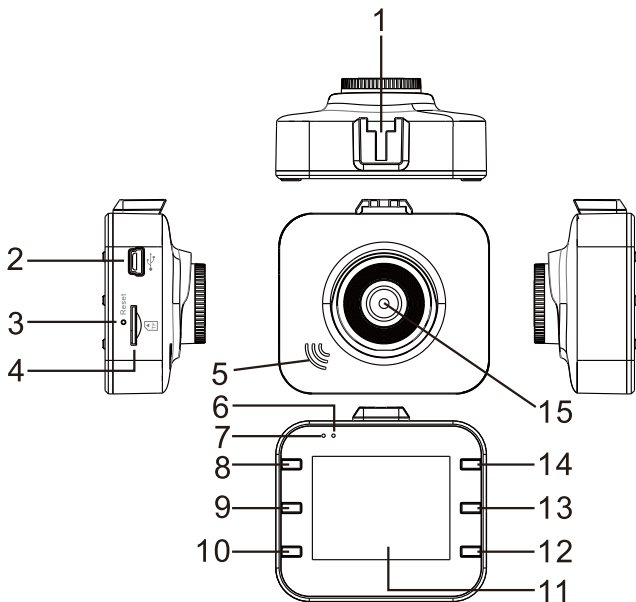

1. Bracket Hole

2. USB Port

3. RESET Key

4. Micro SD Card Slot

5. Speaker

6. Working Indicator Light

7. Power Indicator Light

8. ON/OFF Key

9. MODE Key

10. MENU Key

11. LCD

12. DOWN Key

13. REC Key

14. UP Key

15. Lens

2. Features

1. Support multiple video resolution, such as 1080P, 720P, 480P and etc with superior video and image quality.
2. Built-in microphone/speaker.
3. Voice/Mute shortcut Key.
4. LCD off Shortcut Key.
5. Support high capacity Micro SD Card.
6. Support seamless loop video and as recording as charging.
7. Automatically take video when car engines on. Automatically turn off on delay 5 seconds after car engines off.
8. Support Motion detection.
9. Support SOS and G-SENSOR to prevent important files from being overwritten

3. Function

1. ON/OFF

I. Power on

In the off state, short press ON/OFF key. DVR enters the video mode and start recording automatically with green light flashing. Or DVR is connected with car charger in the off state to enter video mode and start recording automatically. When unplug the charger, DVR will automatically save the current file and shut down in 5 seconds delay.

Note: LCD screen writes 'no card' if Micro SD card not inserted. If the Micro SD card is inserted with DVR in working state, DVR will automatically power off.

II. Power off

In work state, long press ON/OFF key to power off DVR.

Note: In low battery state, DVR display writes 'Low Battery' and automatically saves the current file and shuts down.

2. Battery charging

Two ways to charge:

I. with USB cable



II. with car charger (Suggested)



Note: In charging, red indicator light will be steady on and automatically turn off with full charged.

3. Micro SD Card Insertion

Straightly insert Micro SD Card into the slot in marked direction until hearing 'Di' sound.



Pop up Micro SD Card: Push forward Micro SD Card first and then pop it up
(It is suggested to do it with DVR off)

4. Video

Press ON/OFF key to power on DVR. Green indicator light flashes in video mode. Press the REC key to stop recording and save the current file, then DVR goes into standby mode with green indicator light steady on. In standby mode, press "REC" key to restart recording. Press again to stop recording.

In standby mode, press ON/OFF key to turn on/off the sound.

In video mode, press UP key to choose LCD on or off to be on energy saving mode.

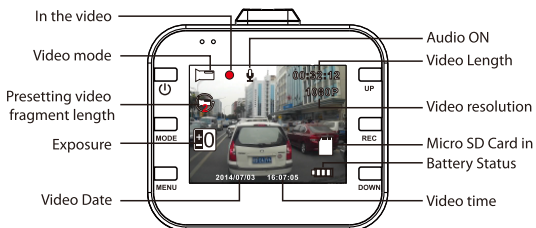

5. Photo

In standby mode, press MODE key to enter into photo mode. Press REC key to take photos with sound prompt. In photo mode, press UP key to choose LCD on or off to be in energy saving mode.



6. Playback and Delete

In standby mode, short press MODE key twice to enter into playback mode. Press UP/DOWN key to select the file. REC key is used for play or pause; If you want to delete files, press MENU key to be in Delete menu. UP/DOWN key is used to be in delete mode. Press REC key to confirm operation. Select 'delete current' or 'delete all' and press REC key to delete. Press MENU key to exit Delete mode and go back to playback mode.

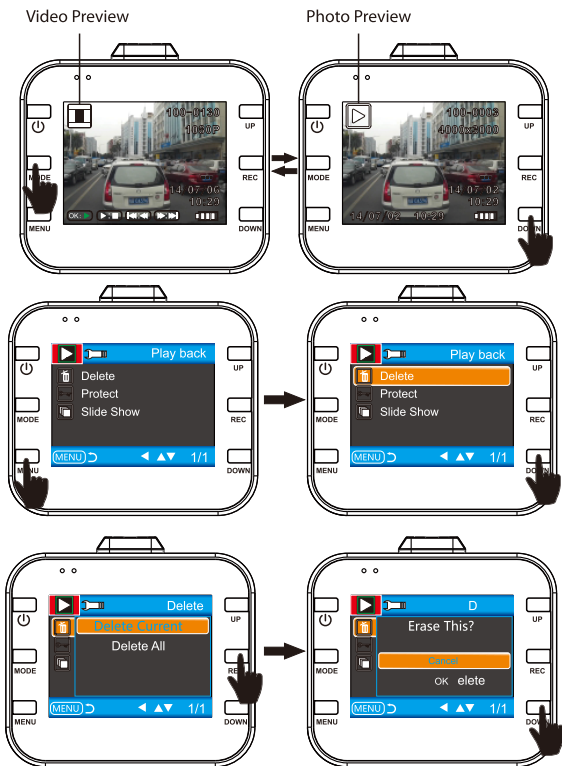

7. SOS

In video mode, short press MENU key to save the file manually in case of important files are lost.

Description: press MENU key in the first 10 seconds of the video clip, the current and previous video clip are saved. If in the last 10 seconds of the video clip, the current and the next video clip are saved. If in the middle, the current video clip is only saved.

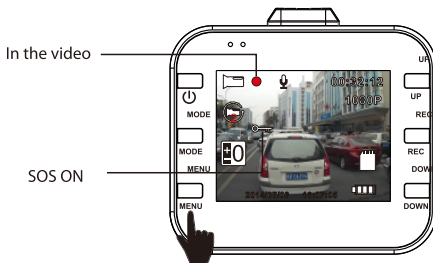

8. G-SENSOR

In video mode, the car brakes suddenly or hit heavily, G-sensor will activate to prevent the current vide clip from overwritten. Three grades setting (high, medium, low) is to cater for different car owners. The description is as same as that of SOS.

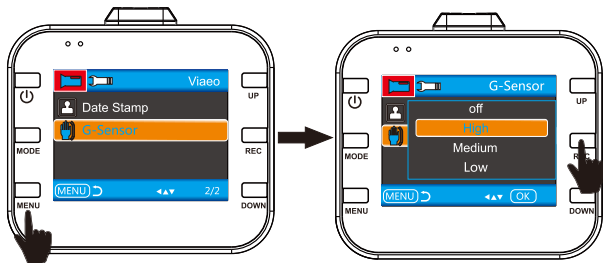

9. Motion Detection Shortcut Key

In standby mode, press DOWN key to enter into motion detection directly. When DVR detects moving objects, it starts to record. If there is no movement for 5 seconds, DVR stops to record and enters into motion detection mode. DVR records again when detecting any movement. Press DOWN key, DVR exits motion detection mode after saving video clip.



Video Standby Mode

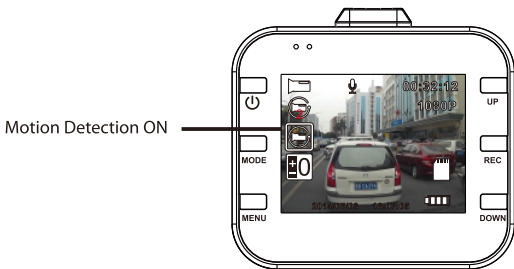
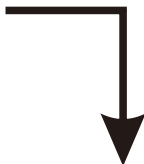

Motion Detection Mode

4. System Setting

In standby mode, press MENU key to enter system setting. Press UP/DOWN key to select the setting item and press REC key to be in sub-categories. Press UP or DOWN key to select the specific parameters and press REC to confirm finally. To exit system setting, please press MENU key.
Here is Specific Categories.

MODE	Category	Sub-Category	Remark
Video	Resolution	1080FHD 1920x1080 1080P 1440x1080 720P 1280x720 WVGA 848x480 VGA 640x480	Factory default: 1440x1080
	Loop Recording	off/30 seconds/1 minute/2 minutes	Factory default: 1 minute
	Exposure	+2.0, +5/3, +4/3, +1.0, +2/3, +1/3, +0.0, -1/3, -2/3, -1.0, -4/3, -5/3, -2.0	Factory default: +0.0
	Voice Recording	Off/on	Factory default: On
	G-Sensor	Off/high/medium/low	Factory default: Medium
	Date stamp	Off/on	Factory default: On
Photo	Capture Mode	Single/2s timer/5s timer/10s timer	Factory default: Single
	Resolution	12M/10M/8M/5M/3M/2MHD/VGA/1.3M	Factory default: 8M
	Sequence	Off/on	Factory default: Off
	Quality	Fine/Normal/Economy	Factory default: Normal
	Sharpness	Strong/Normal/Soft	Factory default: Normal
	White Balance	Auto/daylight/cloudy/tungsten/Fluorescent	Factory default: Auto
	Color	Color/Black & White/Sepia	Factory default: Color
	ISO	AUTO/100/200/400	Factory default: Auto
	Exposure	+0.0, -1/3, -2/3, -1.0, -4/3, -5/3, -2.0, +2.0, +5/3, +4/3, +1.0, +2/3, +1/3	Factory default: +0.0
	Anti-shaking	Off/on	Factory default: off
	Quick Preview	Off/2 Seconds/5 Seconds	Factory default: 2 Seconds
Date Stamp	Off, date, date/time	Factory default: Date/Time	
Playback	Delete	Delete current/Delete all	
	Protect	Lock Current/Unlock Current/Lock All/Unlock All	
	Slide Preview	2 seconds/5 seconds/8 seconds	

System Setting	Date/Time	MM/DD/YY, DD/MM/YY, YY/MM/DD	
	Auto Power off	Off/1 minute/3 minutes	Factory default: off
	Beep Sound	Off/on	Factory default: on
	Language	English/Français/Español/Português/Deutsch/Italiano/Român/ 繁體中文/Русский/日本語/Polksi	
	Frequency	50Hz/60Hz	
	Format	Micro SD Card	
	LCD OFF	Off/1 minute/2 minutes/5 minutes	Factory default: 1 minute
	Default setting	Factory Default/Cancel/OK	
Version	The current version number		

5. Connected to the Computer

Video and Photo Download

1. When USB cable connects to your computer and DVR, red indicator light will be steady on. The screen pops up categories- Mass Storage and PC Camera.
2. If select Mass Storage and DVR screen changes to be blue. The Micro SD card disk will be recognized by computer.
3. Use computer to browse and manage files
4. When select PC Camera, DVR can be used as PC Camera and DVR screen changes to be blue. Long press ON/OFF key and pull out the USB cable to power it off.
5. Press ON/OFF key to power off DVR to be battery charge. The red indicator light will be steady on.

Note: Improper operation can be caused DVR crash. Please use small hard objects to press the reset key, When DVR restarts, it is back to normal.

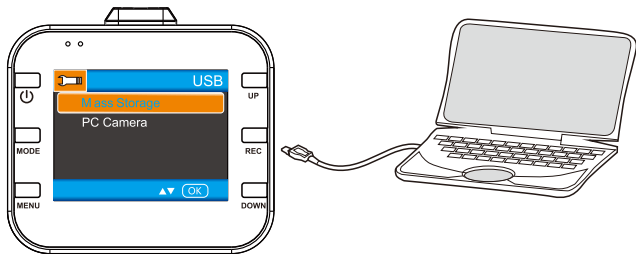

6. Product Specification

Note: Specification may change due to upgrades. Please take the objects as standards.

LCD Size	2.0 inch TFT Screen
CMOS Sensor	1.0MP
Viewing Angle	120 degree ultra-wide viewing angle
Minimum Illumination	1LUX
Video Resolution	1080P/720P/480P
Video Format	AVI@MJPEG
Frames	25fps under 1080P 30fps under 720P 1480P
Image Resolution	12M/10M/8M/5M/3M/2MHD/VGA/1.3M
Image Format	JPG
Motion Detection	Support
Loop Recording	off/30s/1 min/2mins
Memory card	Micro SD Card
Memory card Capacity	Max. 32GB
Output	USB2.0
Power Port	USB5V 1000mA
Power Frequency	50HZ/60HZ
Battery Capacity	300mAH
Microphone/Speaker	Built-in
Language	English/Français/Español/Português/Deutsch/Italiano/ Român/ / 繁體中文/Русский/日本語/PolSKI
DVR N.W.	50g
DVR Size	63(L)*30(W)*58(H)mm

7. Accessory

The following accessories are for reference only. Please take objects as standard.
Supplier reserves the rights to change without prior notice.



DVR



Bracket

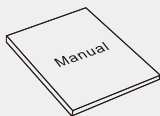

Manual



Car Charger



USB Cable