

# Owner's Manual



Issue Date: April 2022

NOTE: Carefully read and follow the instructions provided in this manual and keep it in a safe place for future reference if you have any doubt whatsoever regarding the use or care of your vehicle, please visit our Mahindra website [www.mahindra.com](http://www.mahindra.com) or contact MAHINDRA S MAHINDRA LTD GATEWAY BUILDING, APOLLO BUILDING, KOLKATA - 700 039

[www.mahindra.com](http://www.mahindra.com)

## INSTRUMENT CLUSTER FEATURES

### 3.14 Partial Alerts

Display	Operating Conditions	Display	Operating Conditions
	This message comes when auto light is turned OFF.		This message comes when cruise mode is turned ON.
	This message comes when auto light is turned ON.		This message comes when cruise mode is turned OFF.
	This message comes when auto wiper is turned OFF.		This message comes on when HDC function is enabled by pressing the HDC switch and the conditions for maintain the vehicle speed while descending the Hill
	This message comes when auto wiper is turned ON.		This message comes when brake pedal is pressed when in cruise mode or if trying to activate cruise control when vehicle speed is below the cruise threshold.

## CONVENIENCE SYSTEMS 2

### 7.2.2 Smart operations in Ignition ON State

#### a). Using Alexa Voice Command

User can open and close Sunroof via voice command through Alexa during Ignition ON.

. Alexa, Open Sunroof . Alexa, Close Sunroof

User can open and close driver side power window via Voice command through Alexa during Ignition ON (will open/close only driver side window)

. Alexa, Open Windows . Alexa, Close Windows

#### b). While Wiper is ON

**Sunroof & Power Window Smart Close**- During Ignition ON condition, if front wiper is ON for approximately around 10 seconds (varies based on wiper modes), a notification requesting user confirmation for closing the Power Window & Sunroof will be displayed. On confirming the same, both will be closed.

**▲ NOTICE**  
User set PIN will be required to execute Android commands

#### c). Timer Based Control (Applicable only for RLS variants)

**Sunroof Smart Close** - During Ignition off, If Sunroof is open for more than a predefined time (for approximately 12 hours), sunroof will get closed automatically.

#### d). Rain detection based control (Applicable only for RLS variants)

**Sunroof Smart Close** - During Ignition off and above rain in

## STARTING AND DRIVING 2

3.32

© Copyright Mahindra and Mahindra Ltd. 2022

### Tyre Auto Learn Process (If Enabled in cluster)



In case of tyre location changed from its original location, automatically tyre swap location shall be identified and pressure and temperature value for respective tyre shall be updated within 10 min. of vehicle driving based on environmental condition & vehicle drive condition auto location shall take one or more drive cycle to auto learn. In case of a new TPMS replaced in the tyre, automatically system shall identify the tyre swapped location and update the warnings and alert for new location.

### ▲ NOTICE

If spare wheel tyre get swapped with any of the remaining tyres then display shall show 'Spare missing in the cluster' for respective tyre location and TPMS indication lamp will blink for 30 sec. and

### Tyre Fill Assist (TFA) (If Enabled in cluster)



During Air filling in tyre, Hazard lamps shall blink until placard value reaches. During air filling if tyre pressure has reached the Placard Value, then Horn shall activate one time

During Air filling if Tyre Pressure exceeds Placard Value, then Hazard lamps shall blink at faster rate.

### ▲ NOTICE

After cluster settings for the "Tyre Fill Assist" in the Instrument Cluster Features" chapter for further details

SCORPIO All 1500 cc models (for full specs, visit)

**Mahindra**

# Owner's Manual



Issue Date: April 2022

INSTRUMENT CLUSTER

3.14 Partial Alert

Display

mm	
2750	
4662	
1917	
1870	
1580	



**Rear View**

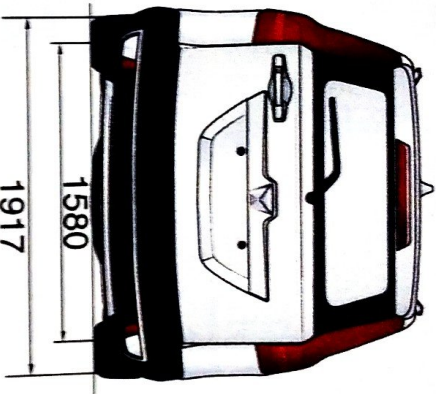

**Side View**

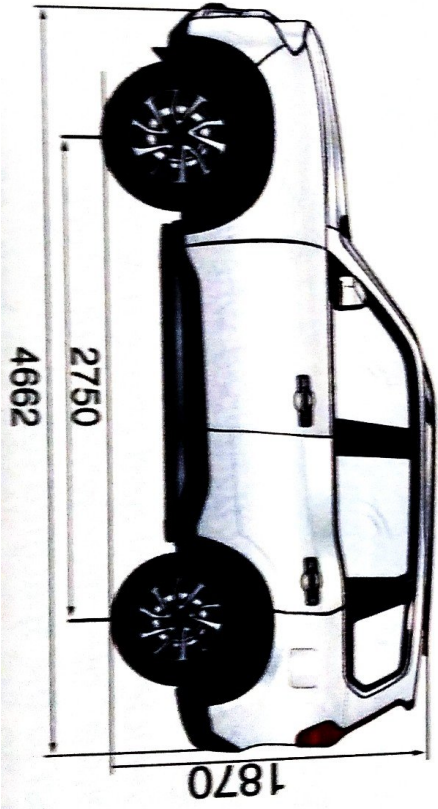

**system - with**

Engine Stop/Star the engine when turn gives a bett

**8.14.1 Engine**

**1**

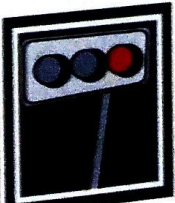

Stop at Traffic Signal/Lam

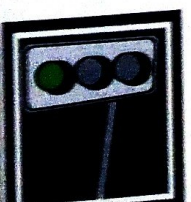

Clearance of Signal/Lam

**OTHER FEATURES**

**Temperature Warning**

Temperature warning lamp in the same lamp when the temperature is continuously ON above 115°C.

When the engine is overheated, the warning lamp will not be illuminated.

When the DPF is full, it will blink. Follow the instructions in the 'DIESEL PARTICULATE FILTER SYSTEM'.



**GENERAL AND SAFETY PRECAUTION**

**1.9 Rear Overview**



A	Roof Antenna
B	Outside Rearview Mirror (ORVM)
C	Foot Step
D	Reverse Lamp
E	Reflector
F	Reverse Parking Assistance Sensors (RPAS)
G	Spare Wheel
H	Tow Hook Cap
I	Tail Lamp
J	Rear View Camera*
K	Stop Lamp
L	Rear Wiper*
M	High Mounted Stop Lamp

\* - if equipped

**e-Call# :**

In an unfortunate event of your car meeting with an accident, triggering the airbags, your Scorpio-N will initiate the following actions -

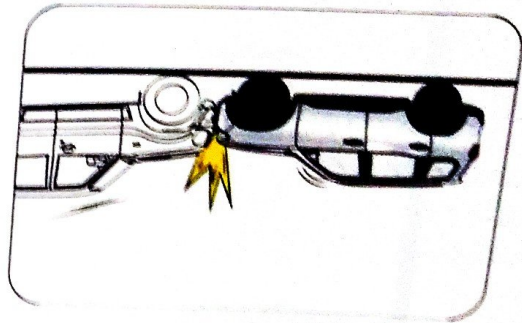

1. A call will be triggered automatically from your Scorpio-N to 108\* Ambulance Service for medical assistance

2. Mahindra With You Hamesha team will call you back for support and guidance



\* [108] number is the default option. This number can be changed based on

**SOS Call from vehicle**



**SOS button in Center Fascia Switch**

For SOS call, the driver can either operate the switch located in Center Fascia Switch ① or touch the SOS icon in the Infotainment



**SOS button in infotainment**

**RSA call from vehicle**

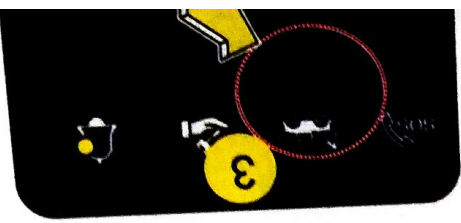

By touching the RSA icon in the infotainment, your Scorpio-N will connect you to Mahindra With You Roadside Assistance

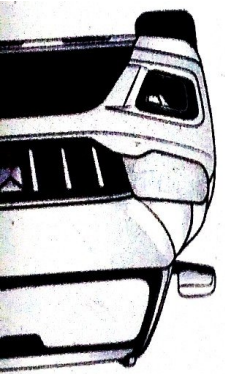

Front Camera  
PPAS sensors are  
front bumper to a

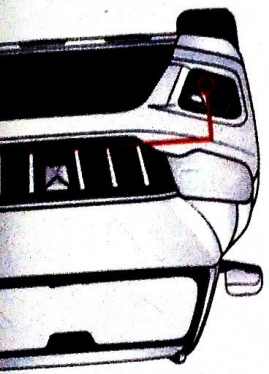

Parking

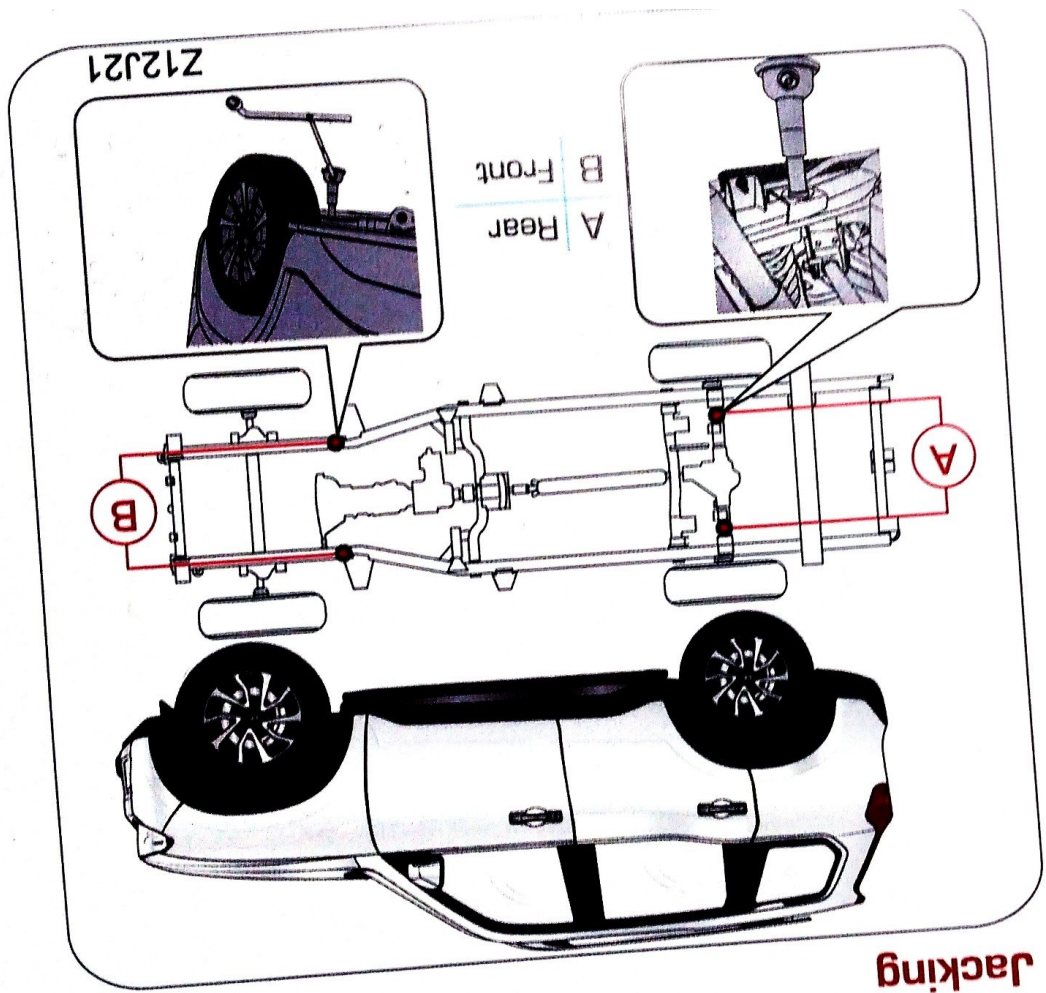

cushion.  
warning

ncis Chapter]

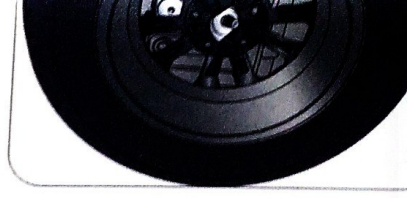
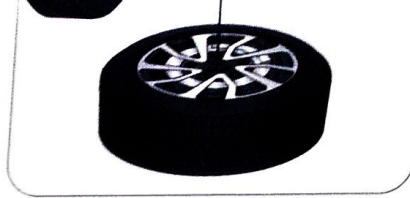

Tilt and Remove the securing bracket out of the spare wheel hub  
Remove/pull away the spare wheel

\*- if equipped / select models or variants only **Note:** Refer Owner's Manual for more

### Parking Assistance System (PAS) - RPAS & FPAS \*

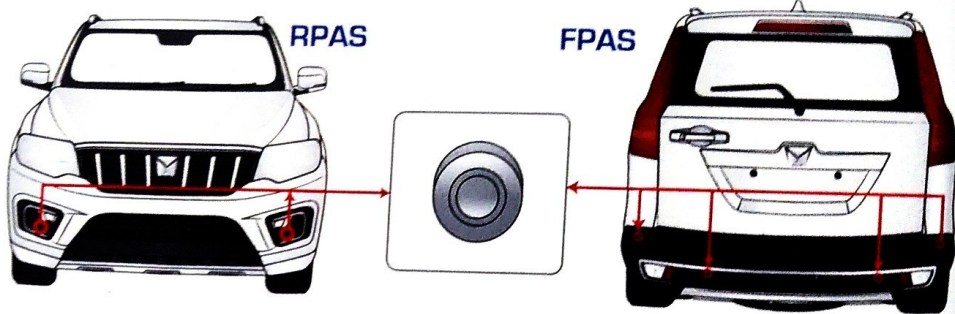

RPAS sensors are located in the rear bumper and FPAS sensors are located in front Bumper to assist driver for hassle free parking.

### Front Camera



Front View Camera is located on front grill applique.

### Rear Camera

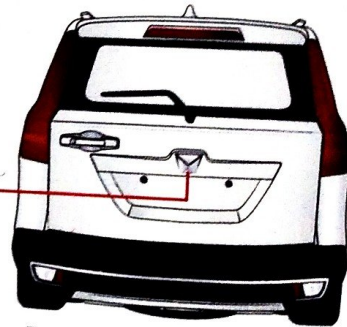

Rear View Camera is located under tail gate applique.

\*- if equipped / select models or variants only **Note:** Refer Owner's Manual for more detail

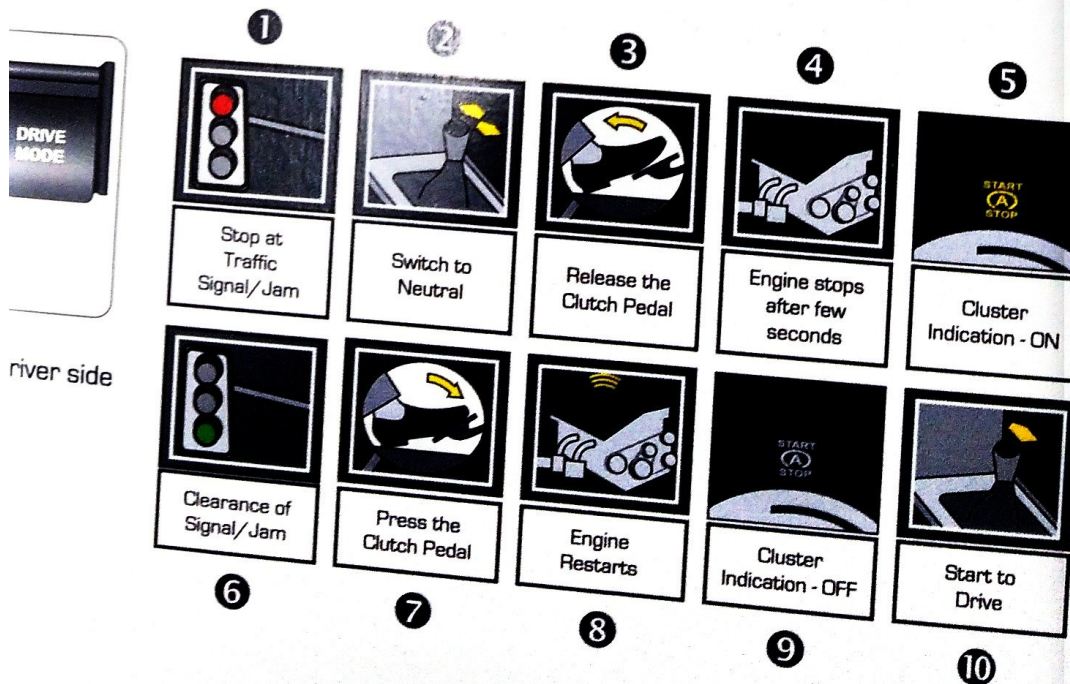

⋮ Rear Wiper-OFF Mode

Rear Wiper Switch

### Temperature Control \*

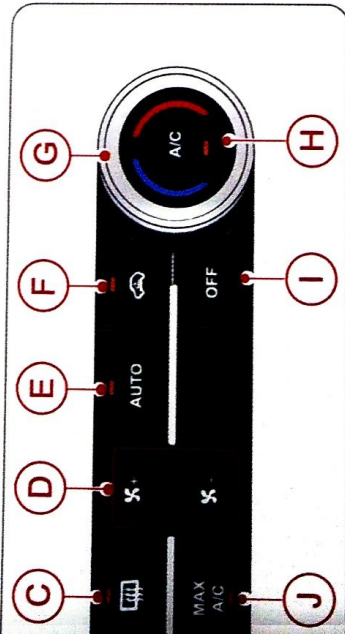

### Temperature Control \*

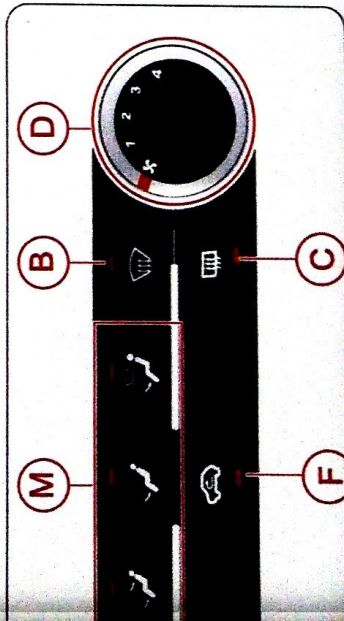

- A High Beam
- B High Beam Flash

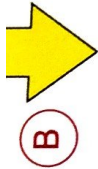

⋮ select models or variants only **Note:** Refer Owner's Manual for more details.

### Heating, Ventilation And Air-conditioning System (HVAC)

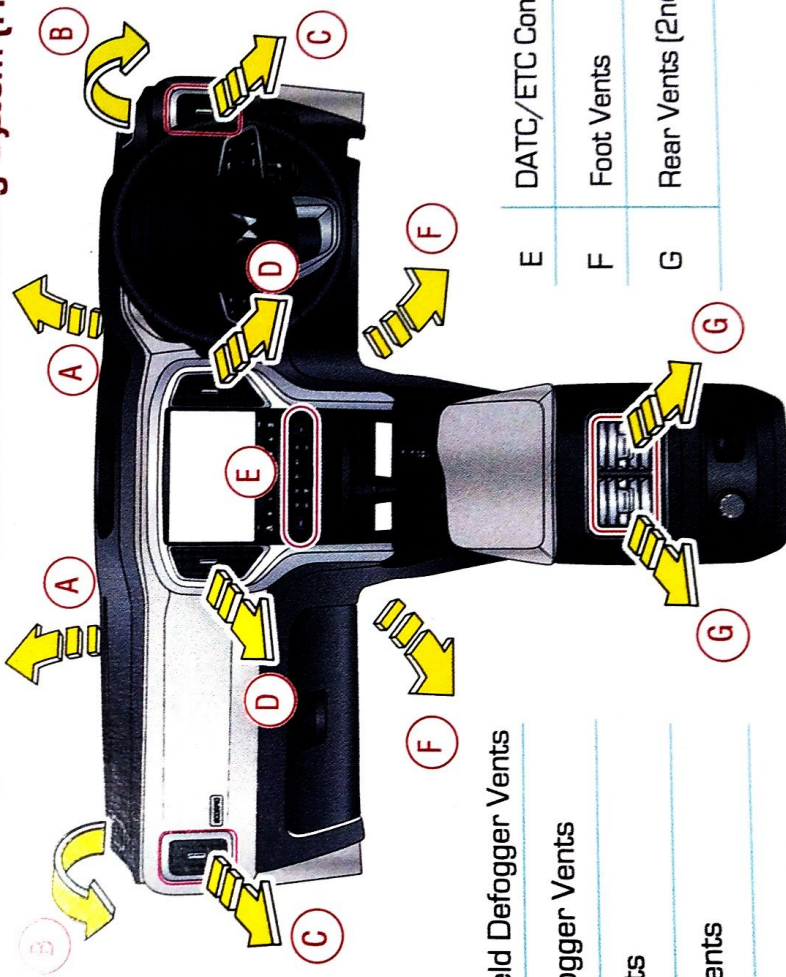

A	Windshield Defogger Vents
B	Side Defogger Vents
C	Side Vents
D	Center Vents

E	DATC/ETC Control Panel
F	Foot Vents
G	Rear Vents (2nd Row)

### Second Row AC





Note: Refer Owner's Manual for more details.

**Instrument Cluster - LOW**

Note: Few Tell Tails of the instrument cluster may vary based on tail tale status.



Note: Refer Owner's Manual for more details.

**Dashboard**

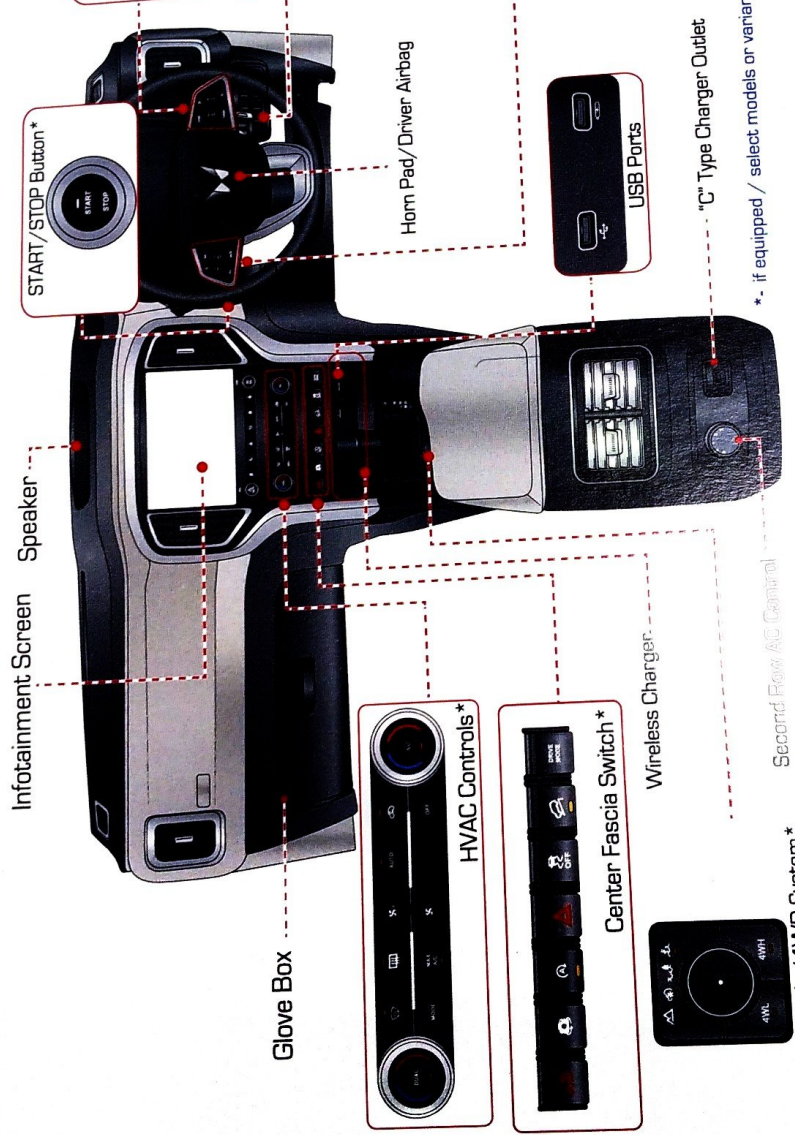

\*. if equipped / select models or variants only **Note:** Refer Owner's Manual for more details.

**Instrument Cluster - HIGH**

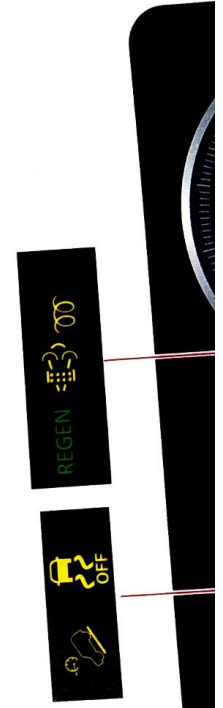

Second Row A/C Control

4xPFLOR Mode/4WD System\*

AS sensors are located in the rear bumper and FPAS sensors are located in front Bumper to assist driver for hassle free parking.

### Front Camera

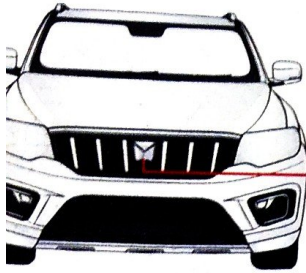

Front View Camera is located in front grille applique.

### Rear Camera

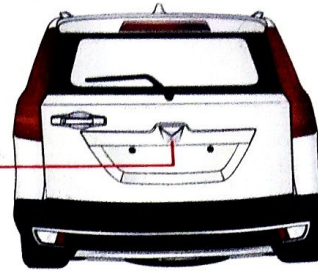

Rear View Camera is located under tail gate applique.

\*- if equipped / select models or variants only **Note:** Refer Owner's Manual for more details.

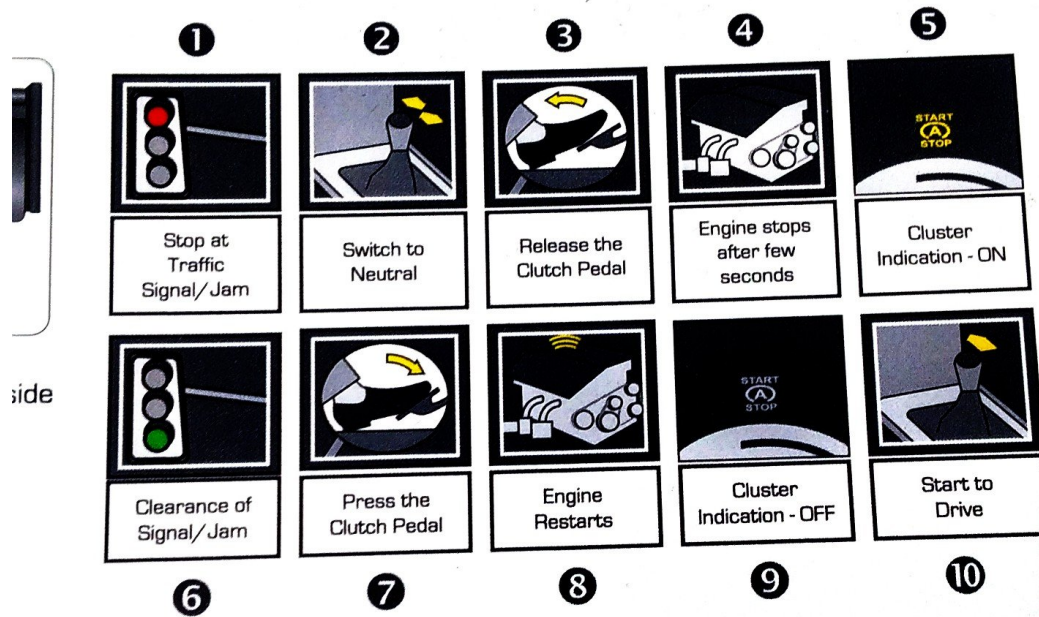

side

equipped / select models or variants only

**Note:** Refer Owner's Manual for more details

### Control\*

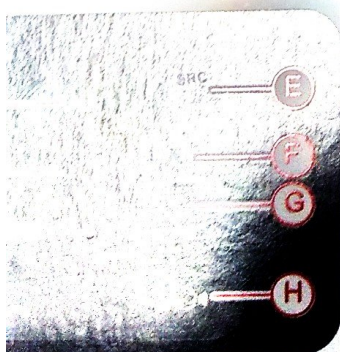

A	Mute	E	Source
B	Volume +	F	SEEK UP
C	Volume -	G	SEEK DOWN
D	Call Connect	H	Voice / Call Disconnect

E - Press SOURCE button to toggle between TUNER, USB, BT AUDIO and MY DRIVE

Press '+' and '-' button to increase or decrease the volume

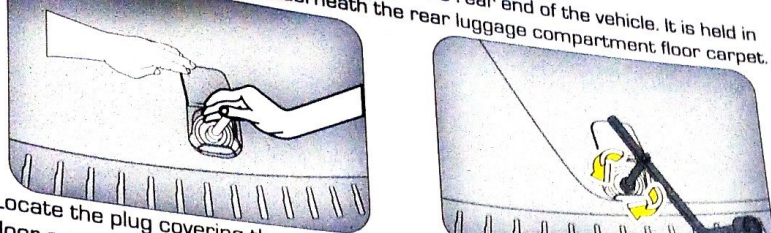

Locate the plug covering the securing nut below the rear luggage compartment floor carpet and remove the plug  
Loosen the securing nut anti-clockwise to winch down/lower the secured spare wheel to the ground

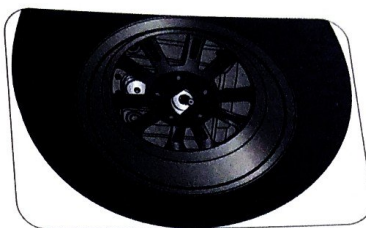
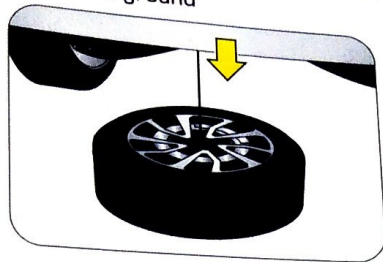

9  
apter]

Tilt and Remove the securing bracket out of the spare wheel hub  
Remove/pull away the spare wheel

\*- if equipped / select models or variants only **Note:** Refer Owner's Manual for more details.

### Parking Assistance System (PAS) - RPAS & FPAS \*

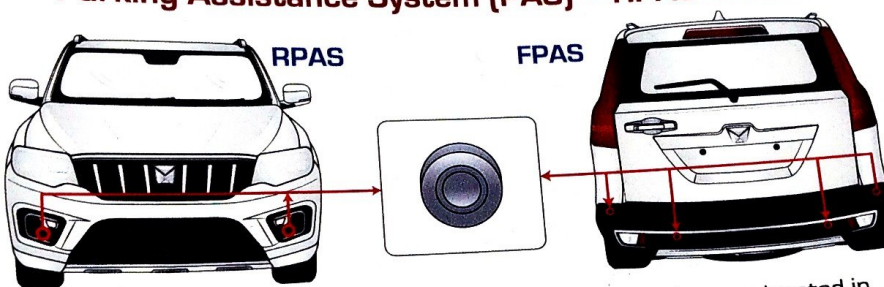

RPAS sensors are located in the rear bumper and FPAS sensors are located in front Bumper to assist driver for hassle free parking.

### Front Camera

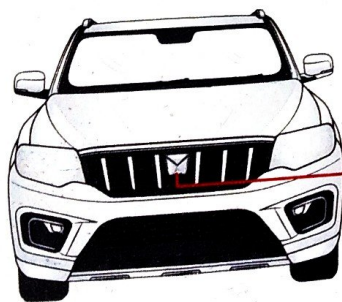

Front View Camera is located on front grill applique.

### Rear Camera

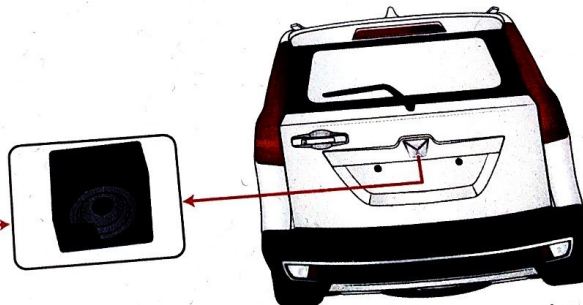

Rear View Camera is located under tail gate applique.

\*- if equipped / select models or variants only **Note:** Refer Owner's Manual for more details.

1 Stop at Traffic Signal/Jam

2 Switch to Neutral

3 Release the Clutch Pedal

4 Engine stops after few seconds

driver side



The tool kit is located behind the third row seats on the floor.

### Warning Triangle

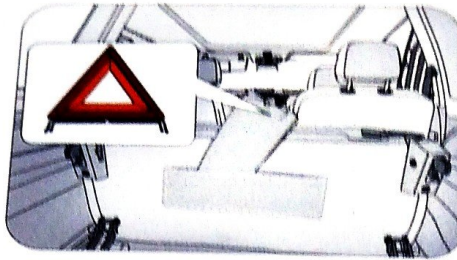

It is placed below the 3rd row seat cushion. Fold the 3rd row seat to access the warning triangle.

Refer the Owner's Manual (Emergency) for more details.

### Jacking

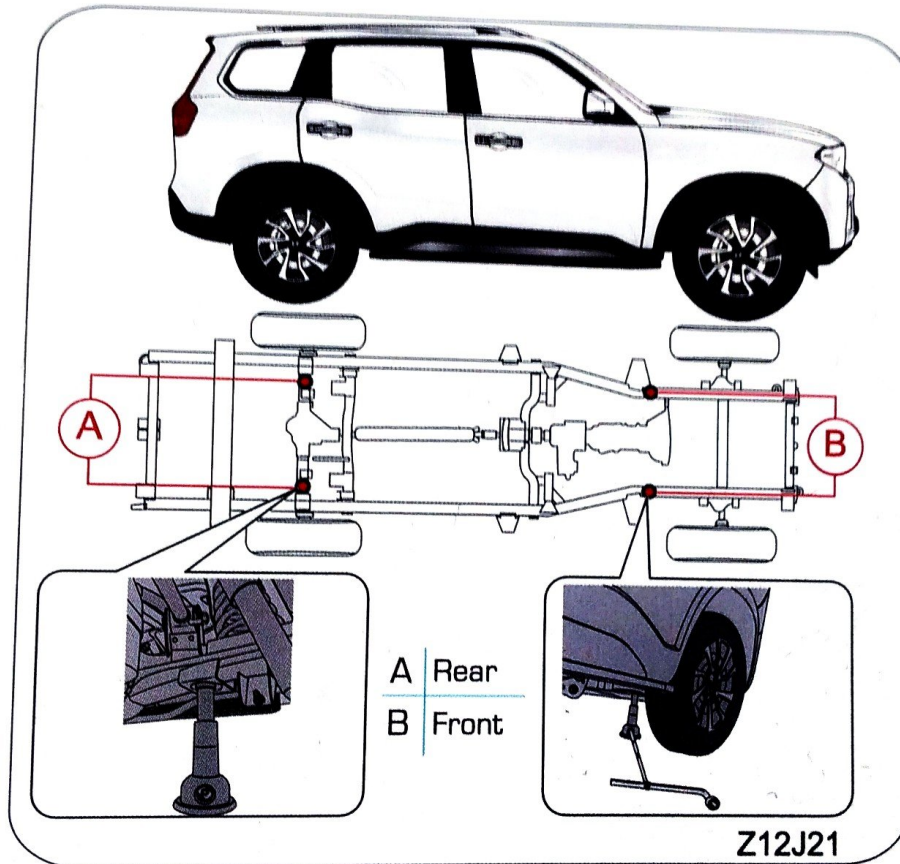

### Engine Stop/Start Button

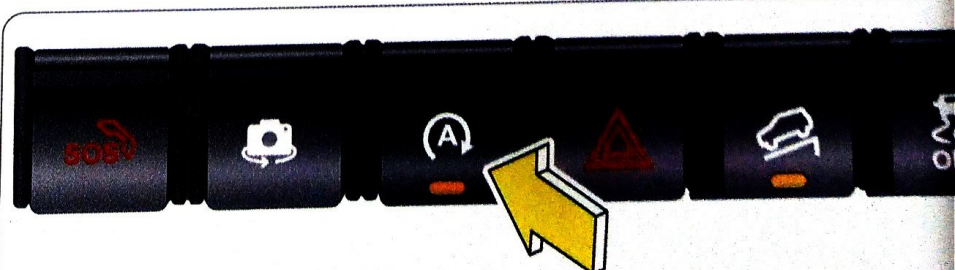

### Interior Mirrors

**Interior Rear View Mirror:** This mirror is located behind the driver's seat. It can be adjusted to view the rear of the vehicle. It has a day/night lever to reduce glare from headlights at night.

**Exterior Side View Mirrors:** These mirrors are located on the left and right sides of the vehicle. They can be adjusted to view the side and rear of the vehicle. They have a heating function to prevent fogging.

### Interior Door Locks

**Interior Door Locks:** These locks are located on the interior side of the front and rear doors. They can be used to lock the doors from the inside.

**Trunk Lock:** The trunk lock is located behind the third row seats on the rear. It can be used to lock the trunk from the inside.

### Warning Triangle

The warning triangle is used to warn other drivers of a vehicle breakdown. It should be placed behind the third row seat, outside the vehicle, in a clear area.

**Tools Kit:** A set of tools is provided in the vehicle for emergency use. It is located in the trunk area.

### Jacking

**Jacking:** The vehicle can be jacked up for tire changes or repairs. The jacking points are located at the front and rear of the vehicle. The jack is located in the trunk area.

**RPAS and FPAS:** The Rear Parking Assistance System (RPAS) and Front Parking Assistance System (FPAS) are used to detect obstacles in the rear and front of the vehicle. The sensors are located in the rear and front bumpers.

### Front and Rear Camera

**Front Camera:** The front view camera is located on the front grille. It provides a clear view of the road ahead.

**Rear Camera:** The rear view camera is located under the tailgate. It provides a clear view of the area behind the vehicle.

### Engine Stop/Start Button

The engine stop/start system is used to automatically stop the engine when the vehicle is parked and start it when the driver gets in. The button is located on the driver's side dashboard.

**Engine Stop/Start Sequence:**

- Stop at Traffic Signal/Jern
- Shift to Neutral
- Release the Clutch Pedal
- Engine stops after few seconds
- Cluster Indication - ON
- Clearance of Signal/Jern
- Press the Clutch Pedal
- Engine restarts
- Cluster Indication - OFF
- Start to Drive

### Cruise Control

**Cruise Control:** This system allows you to maintain a set speed without the need to keep your foot on the accelerator pedal. It is used on highways and roads with a steady speed limit.

**Audio Control:** The audio control panel is used to operate the infotainment system. It includes buttons for volume, mute, and source selection.

### Audio Control

**Audio Control Buttons:**

- A: Mute
- B: Volume +
- C: Volume -
- D: Call Connect
- E: Source
- F: SEEK UP
- G: SEEK DOWN
- H: Voice / Call Disconnect

### Engine Stop/Start Button

The engine stop/start system is activated by the Engine Stop/Start button in the driver's side dashboard. The LED on the button indicates the status of the button.

**Engine Stop/Start System:**

- To activate:** Drive the vehicle to the desired Cruising speed (any value greater than 20 kmph, press the SET+ button).
- To deactivate:** Press the CRUISE OFF button in the steering wheel, or Press the brake pedal.
- SET + button:** activate Cruise Control and also to increase the Cruise Set speed.
- SET - button:** decrease the Cruise Set speed in small amounts.

### Audio Control

**Audio Control Buttons:**

- A: Mute
- B: Volume +
- C: Volume -
- D: Call Connect
- E: Source
- F: SEEK UP
- G: SEEK DOWN
- H: Voice / Call Disconnect

**Audio Control Functions:**

- SOURCE:** Press SOURCE button to toggle between TUNER, USB, BT AUDIO and MY DRIVE
- VOLUME CONTROL:** Press '+' and '-' button to increase or decrease the volume
- MUTE:** Press MUTE button to mute audio while in TUNER mode and pause the song while in USB mode
- USB MODE:** Press the seek button 'UP' / 'DOWN' moves to next / previous track or MP3 and video Playing
- TUNER MODE:** Press the seek 'UP' / 'DOWN' button briefly. Manual Search, move selected channel. Press and hold the seek button 'UP' / 'DOWN' for seconds to AUTO Search
- Call Connect:** Press to accept incoming call to the paired BT phone.
- Call Disconnect:** Press to reject or end active call to the paired BT phone.
- Call Disconnect:** Press to activate Alexa or OK Google or Siri voice assistant

### Driver Facade Switch\*

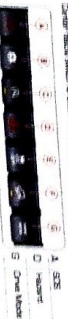

### Wireless Mobile Charging\*



### Microphone\*



### Power Windows



The Driver Facade Switch is located in the center of the instrument panel. There are three types of control: manual switching, automatic, and memory.

1. SRS  
2. SRS  
3. SRS  
4. SRS  
5. SRS

A wireless mobile charging pad is located on the dashboard. To use the pad, simply place your smartphone on the pad. The pad will automatically detect the phone and begin charging. The pad is compatible with most smartphones.

The microphone is located on the dashboard. It is used for voice commands and hands-free calling. To use the microphone, simply speak into it. The microphone is always on, but it only records when you are speaking.

The power windows are controlled by the power window controls on the driver's side door. To open a window, simply press the corresponding button. To close a window, simply press the corresponding button. The power windows are also controlled by the power window controls on the center console.

The power windows are controlled by the power window controls on the driver's side door. To open a window, simply press the corresponding button. To close a window, simply press the corresponding button. The power windows are also controlled by the power window controls on the center console.

### SOS Calling\*



The SOS Calling button is located on the dashboard. It is used to call emergency services in the event of an emergency. To use the button, simply press it. The button will automatically call emergency services and provide your location.

The SOS Calling button is located on the dashboard. It is used to call emergency services in the event of an emergency. To use the button, simply press it. The button will automatically call emergency services and provide your location.

The SOS Calling button is located on the dashboard. It is used to call emergency services in the event of an emergency. To use the button, simply press it. The button will automatically call emergency services and provide your location.

The SOS Calling button is located on the dashboard. It is used to call emergency services in the event of an emergency. To use the button, simply press it. The button will automatically call emergency services and provide your location.

### Interior Rear-View Mirror



The interior rear-view mirror is used to view the rear of the vehicle. To adjust the mirror, simply move the adjustment lever up or down. The mirror will automatically adjust to the selected position.

### Electric Adjustable OVM\*



The electric adjustable interior rear-view mirror is used to view the rear of the vehicle. To adjust the mirror, simply press the corresponding button on the center console. The mirror will automatically adjust to the selected position.

### 3rd Row Roof Lamp\*



The 3rd row roof lamp is used to illuminate the 3rd row of the vehicle. To turn the lamp on or off, simply press the corresponding button on the center console.

### Front Sport Lamp



The front sport lamp is used to illuminate the front of the vehicle. To turn the lamp on or off, simply press the corresponding button on the center console.

### Manual Transmission\*



The manual transmission is used to shift the vehicle into different gears. To shift, simply move the gear shift lever to the desired gear. The gear shift lever is located on the center console.

### Automatic Transmission (AT)\*



The automatic transmission is used to shift the vehicle into different gears. To shift, simply move the gear shift lever to the desired gear. The gear shift lever is located on the center console.

### Toolbox

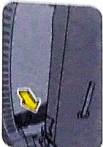

The toolbox is located in the trunk of the vehicle. It contains various tools and equipment that may be needed in an emergency. To access the toolbox, simply open the trunk and look for the toolbox.

### Warning Triangle

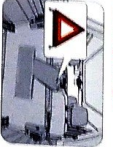

The warning triangle is used to warn other drivers of a vehicle breakdown. To use the warning triangle, simply place it in a visible location on the side of the road. The warning triangle is located in the trunk of the vehicle.

### Landing

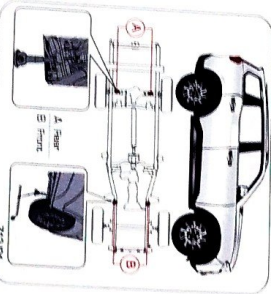

### Engine Stop/Start Button



The engine stop/start button is used to start and stop the engine. To start the engine, simply press the button. To stop the engine, simply press the button again. The engine stop/start button is located on the dashboard.

### 3rd Row Power Window



The 3rd row power window is used to open and close the 3rd row window. To operate the window, simply press the corresponding button on the center console.

### Speed Automatic Transmission



The speed automatic transmission is used to shift the vehicle into different gears. To shift, simply move the gear shift lever to the desired gear. The gear shift lever is located on the center console.

### Spare Wheel Removal



The spare wheel is used to replace a flat tire. To remove the spare wheel, simply follow the steps shown in the diagram. The spare wheel is located in the trunk of the vehicle.

### Front View Camera

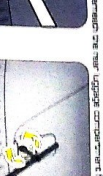

The front view camera is used to provide a forward view of the road. To view the camera feed, simply press the corresponding button on the center console.

### Rear View Camera



The rear view camera is used to provide a rear view of the road. To view the camera feed, simply press the corresponding button on the center console.

### Parking Assistance System (PAS) - RPAS & FPAS\*



The Parking Assistance System (PAS) is used to assist with parking. It includes the front view camera (FPAS) and the rear view camera (RPAS). To use the PAS, simply press the corresponding button on the center console.



The front view camera (FPAS) is used to provide a forward view of the road. To view the camera feed, simply press the corresponding button on the center console.



The rear view camera (RPAS) is used to provide a rear view of the road. To view the camera feed, simply press the corresponding button on the center console.



### Cruise Control\*

The Cruise Control system is used to maintain a set speed without the need to keep your foot on the accelerator pedal. To use the Cruise Control system, simply press the corresponding buttons on the dashboard.

The Cruise Control system is used to maintain a set speed without the need to keep your foot on the accelerator pedal. To use the Cruise Control system, simply press the corresponding buttons on the dashboard.

The Cruise Control system is used to maintain a set speed without the need to keep your foot on the accelerator pedal. To use the Cruise Control system, simply press the corresponding buttons on the dashboard.

The Cruise Control system is used to maintain a set speed without the need to keep your foot on the accelerator pedal. To use the Cruise Control system, simply press the corresponding buttons on the dashboard.

The Cruise Control system is used to maintain a set speed without the need to keep your foot on the accelerator pedal. To use the Cruise Control system, simply press the corresponding buttons on the dashboard.



### Audio Control\*

The Audio Control system is used to control the audio system. To use the Audio Control system, simply press the corresponding buttons on the dashboard.

The Audio Control system is used to control the audio system. To use the Audio Control system, simply press the corresponding buttons on the dashboard.

The Audio Control system is used to control the audio system. To use the Audio Control system, simply press the corresponding buttons on the dashboard.

The Audio Control system is used to control the audio system. To use the Audio Control system, simply press the corresponding buttons on the dashboard.

The Audio Control system is used to control the audio system. To use the Audio Control system, simply press the corresponding buttons on the dashboard.

### NOTICE