

13-3420 Removing and Installing poly V-belt

Preceding work:
Open hood, raise to vertical position (01-0080).

Operation no. of operation texts and work units or standard texts
and flat rates
13-1202 - 13-4001

1st version

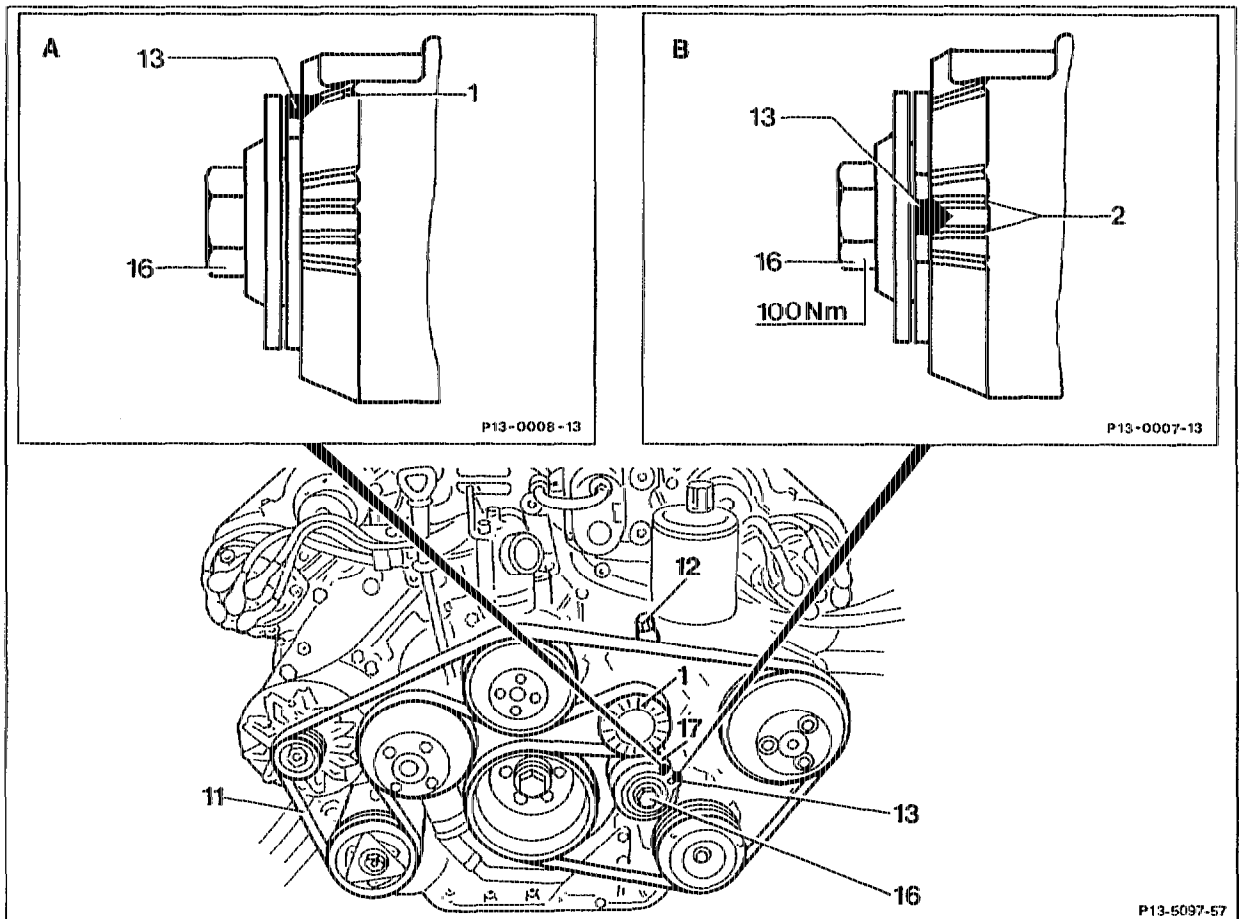

Engine 119.960

- A Setting pointer (13) to marking (1) = poly V-belt slackened
- B Setting pointer (13) to marking (2) = poly V-belt tensioned

Model 124: fan shroud	remove, install.
Models 129, 140: fan shroud ring	take off, place over fan, fit on.
Bolt (16)	slacken about 1/4 - 1/2 turns.
Tensioning nut (5)	slacken (turn to the left).
Poly V-belt	take off.
Belt pulley surfaces	examine for signs of damage and dirt, replace if necessary (e. g. worn bearing points of tensioning device, dents in belt pulleys etc.).

Setting pointer (13)	turn to marking (1).
Poly V-belt	fit on, starting at tensioning pulley (1) (see 13-3440 for running diagrams).
Tensioning nut (12)	tighten until setting pointer (13) is located between the markings (2).
Bolt (16)	tighten (100 Nm).
Seat of belt on belt pulleys	examine.



Do not use belt wax or similar products.

2nd and 3rd version

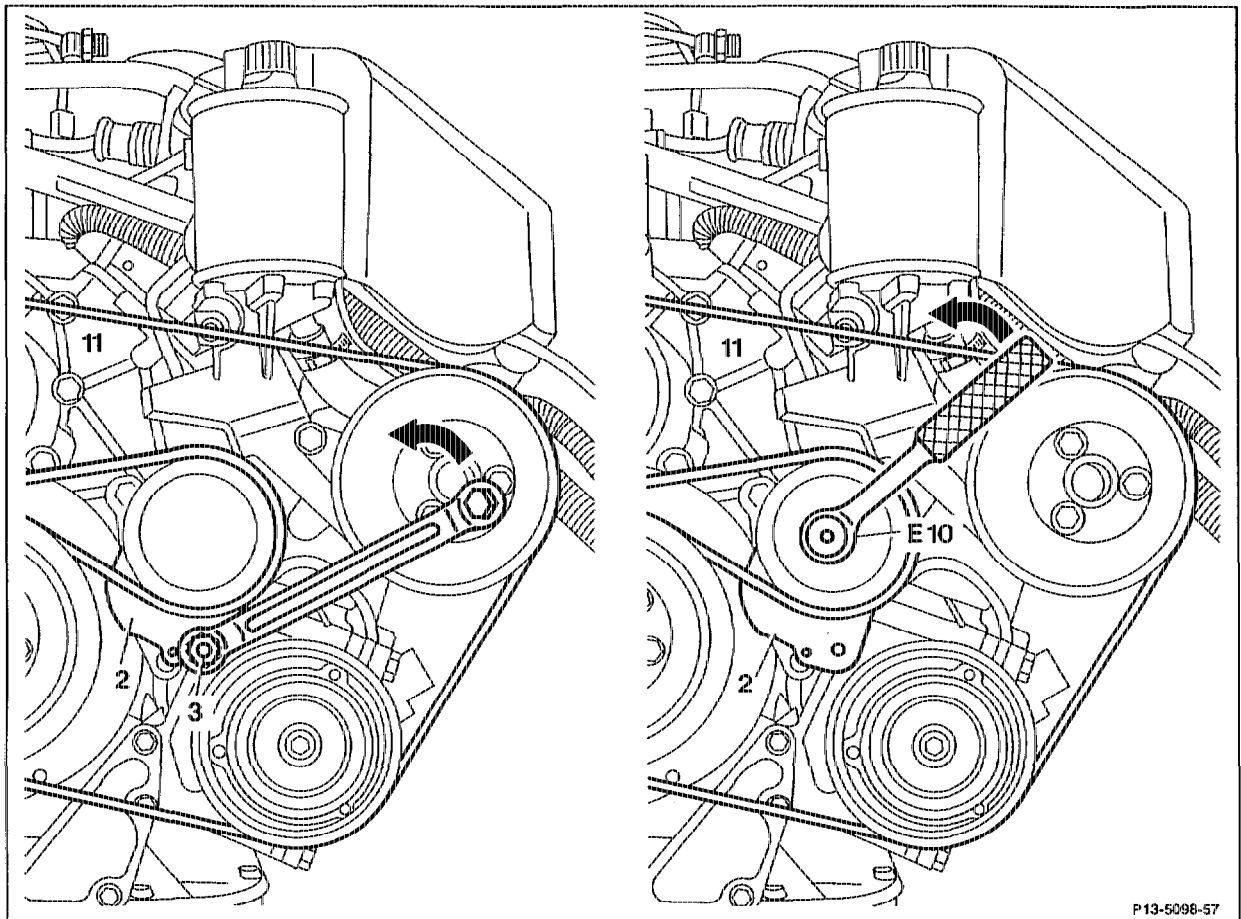

P13-5098-57

2nd version

3rd version

Model 124: fan shroud	remove, install.
Models 129, 140: fan shroud ring	take off, place over fan, fit on.
2nd version: hexagon head (3) on tensioning arm (2)	swivel counter-clockwise with wrench (WAF 17).
3rd version: Torx (E10) in tensioning pulley	swivel counter-clockwise.
Poly V-belt (11)	take off.
Belt pulley surfaces	examine for signs of damage and dirt, replace if necessary (e. g. worn bearing points of tensioning device, dents in belt pulleys etc.).
Poly V-belt (11)	fit on (running diagrams see 13-3440).
	
	Do not use belt wax or similar products.
Seat of belt on belt pulleys	examine.

Special tool

(Tensioning device 1st version)

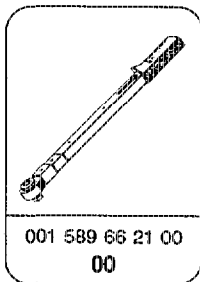

Special tool

(Tensioning device 3rd version)

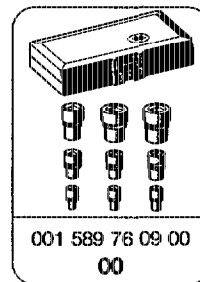

Tightening torque in Nm

Bolt (16) of tensioning device (tensioning device 1st version)	100
--	-----